

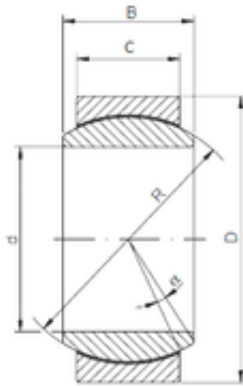

Bearing?Power Machinery Co., Ltd.

ISO GE 060 ECR-2RS plain bearings



Bearing No. GE 060 ECR-2RS

Size	60x90x44 mm
Bore Diameter	60 mm
Outer Diameter	90 mm
Width	44 mm
d	60 mm
D	90 mm
B	44 mm
C	36 mm
R	80 mm
Angle	6 °

GE 060 ECR-2RS Bearing 2D drawings and 3D CAD models